



# REDWOOD

Newsletter of the Redcliffe and District Woodcraft Society Inc.

Editor: Kerry Cameron [kandjcameron@gmail.com](mailto:kandjcameron@gmail.com)

0457 431 232

Issue No.

308

January 2026

## Redcliffe and District Woodcraft Society Inc.

### Clubhouse:

Woodcraft Centre  
463 Oxley Ave  
Redcliffe QLD 4020

Club Email: [redcliffewoodcraft@gmail.com](mailto:redcliffewoodcraft@gmail.com)

### Management Committee

**President:** Ernie Hobson  
0400 621 513  
[erniehobson@outlook.com](mailto:erniehobson@outlook.com)

**Vice President:** Shona McKay  
0408 015 076  
[shonaipad@gmail.com](mailto:shonaipad@gmail.com)

**Secretary:** Ian Ross  
0418 378 305  
[ian.ross200@gmail.com](mailto:ian.ross200@gmail.com)

**Treasurer:** Bill Charlton  
0417 778 968  
[wcharlton7@bigpond.com](mailto:wcharlton7@bigpond.com)

### Committee Members

Neil Evans	0438 099 587
Wendy Hillhecker	0404 900 371
Ian Hunter	0434 282 748
Thadeus Ikihega	0402 098 791
Val Millway	0490 501 836
Rainer Pinno.	0417 825 842
Peter Smallhorne	0418 191 790

## PRESIDENT'S REPORT

Welcome to my January report, I trust you all kept well and had an enjoyable time during the recent festive season. Our December Christmas lunch was a great success with over 50 people in attendance. With lots of raffles and Lucky door prizes it was a fun packed social gathering at the end of a busy year. Thanks to all who contributed in any way with donated goodies for the hampers and to those involved with organising the day. Thanks to the many donations our raffles netted an outstanding \$500.00 for our club funds

Our combined working bee and celebration day on the 16<sup>th</sup> of December was very well attended resulting in very clean and tidy workshops by 10.00am. The celebration morning tea was enjoyed by all members present and our special visitors and supporters State Member Kerri-Ann Dooley and Councillor Karl Winchester. Thanks again to members who supplied some of the goodies, and to Shona for organising the event.

Confirmation from the council that we are to be relocated to a new facility is welcome news. While this will still be several years, the time frame may be shortened considerably if we can get support from all 3 levels of government. We can all help by promoting our club and the benefits to the community. We also welcome discussions with our local, state and federal members.

2026 is shaping up to be another busy year with lots of activities for members to get involved and support our club. Check the weekly bulletin to keep track of what is currently happening and future activities. Don't forget while Tuesdays and Thursdays are our main days; the club is also open on Mondays and Wednesdays where we need a few more members to keep our doors open.

*Continued page 2*

**Presidents Report continued:**

Competency training has already started, and members are reminded to see Robyn Bonner if you wish to add or update your skills on the various machines. The annual refresher courses are scheduled for the 17 & 19 March so please check your current competency status.

The clubs' aim is to provide a venue and facilities for use by community members with a common interest in woodcraft. It also provides comradeship to both men and women from all walks of life and not only provide for their practical interest but also help with their mental wellbeing. The club has created a supportive social network as well as building skills and confidence in a range of woodcraft activities

Ernie Hobson  
President

Our Annual Machine Refresher Training is being held on the 17<sup>th</sup> & 19<sup>th</sup> of March.

We will also be taking a RDWS members group photo on 17/3/2026 after Morning Tea, at about 10.20am.

We encourage ALL members to come along & be in the picture.

Even if you are not attending the Refresher training, come along and be a part of our photo.

If you are uncertain about your Machine competencies, send me a message on 0417825842 and I will forward you a summary of your training record.

Thanks,

Rainer Pinno

Machine Competencies records.

**0417825842**

**Our annual Redcliffe Show Competition is in JUNE** details of the Judging Criteria is shown on the next page, during our Tuesday meeting on the 20<sup>th</sup> January Ken Rays spoke on the merits of using different sizes and shapes for the treatment on the underside of bowls and showed examples, Kerry backed up Ken's comments mentioning the importance of finishing bowl bottoms appropriately particularly for competitions.



Ken's examples of treatment on the underside of bowls.



Rod Meier discussing his first bowl turned following completing a turning course run by Bob Longland and Barry Spillman. A promising contender for a Novice Award this year.

# Welcome to 2026

June will be on us before we know it as will the Redcliffe Show and our **Annual Woodcraft Competition**.

Have you started on your entries for the competition? Whether it be Turning, Carving, Pyrography, Scroll-sawing, boxes, furniture a musical instrument or anything made from wood?

As a helpful guide the judging criteria used by our judges is listed below.

Any questions? Neil Evans or Kerry Cameron can help.

## 12.006 JUDGING CRITERIA

The Judges will award points to each Entry for the Annual Woodcraft Competition on the basis of

CRITERIA	DESCRIPTION	POINTS
<b>DESIGN</b>	Proportion and perspective, line, centre of interest, suitability of purpose, choice of material, aesthetic appeal, artistic appeal and original design concept.	<b>100</b>
<b>WORKMANSHIP AND TECHNIQUE</b>	Evidence of good tool technique, clean edges and corners, accuracy, thicknesses (consistent where appropriate), matching surfaces, grain alignment, tool marks, pick-outs.	<b>100</b>
<b>DEGREE OF DIFFICULTY</b>	Actual degree of difficulty. Use of advanced or non-standard techniques. Complexity	<b>100</b>
<b>FINISH</b>	Absence of sanding marks, even finish, dust free, good feel and texture, appropriate for the entry.	<b>100</b>
	<b>TOTAL</b>	<b>400</b>

The Judges will score each Entry based on a range from Poor to Excellent for each of the four judging elements. The resultant score will be aligned to a numerical range of 0 to 100 for the purpose of determining placegetters.



## Tips and Tricks

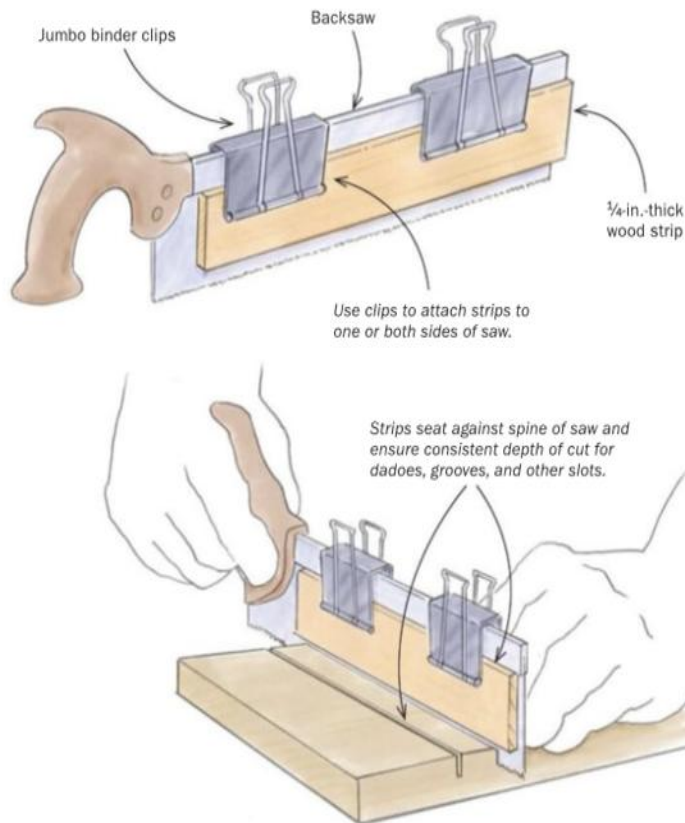

### Add a depth stop to your handsaw

When you use a backsaw to cut grooves, dadoes, or sliding dovetails, here's a simple way to ensure consistent depth.

Attach a 1/4-in.-thick piece of wood to one or both sides of the saw, with the wood pressed against the sawback, or spine, of the saw and held in place with jumbo-size (at least 2 1/4-in.) binder clips.

The width of the wood strips determines the depth of cut. Mark and save your depth-stop pieces, and you can make the same cut every time.

*A Fine Woodworking Tip*



**WOODLAND SHOPFITTING**

**ONE TEAM / ONE GOAL  
SUPPORT OUR SPONSORS**

**ABR/SIFLEX**

**YOUR ABRASIVE SOLUTION**

*I am starting 2026 off by reprinting one from the archives*

## **Making a Sam Maloof style low back chair:** *by Kerry Cameron*

Sam Maloof was a furniture designer and woodworker with his work being in collections of several major museums including the *Smithsonian American Art Museum*. His chairs have a superb sculptural quality about them and after watch a documentary on his life many years ago I was determined to try and create my own version of one of his chairs.

Researching the availability of detailed plans, I found that *Charles Brock, Chairmaker* offered plans backed by a how-to DVD on building sculptured chairs. The design package was ordered and arrived from America shortly after.

Making four low back dining chairs has been a real highlight for me in in my woodworking journey.

I did do a 4-part maker story that was posted in previous issues of Redwood (I think in about 2010) this time I will let the photos convey the story.



The design package from Charles Brock, graphically detailed book and DVD, and full-size template patterns



Sourced the stock required for the chairs from previously harvested camphor laurel and a large slab from Howard Lunt



Managed to mill and size the camphor with the assistance of jigs.







Used the templates to mark out and then cut and shaped,



Cut out the components with the help of a purpose made table saw sled



Joined by biscuits and glued the seat panels together using Titebond glue.



Then it was time to assemble ready for final shaping and sanding.





Shaping, sanding, sanding and more sanding!



Power sanding through the grits and then by hand with finer grits.



The first chair finished ready for oiling. Three more were made over a three-year period, one in Camphor Laurel and two in Silky Oak



In the year of 2020 I finally got around to making the dining table to go with the chairs. The camphor slabs had been in storage for the past 17 years having been harvested from a rural property off the Landsborough/ Maleny road during my first year in the Club.

*P.S. I have great memories and I feel privileged to have enjoyed a well set up, spacious workshop for the past 26 years that enhanced my woodcraft skills, creativity and satisfaction, now I am ready for the next phase of my journey as we downsize and move on!*

*Kerry Cameron*

# Men's Shed 12

Salamander Mens Shed - Salamander Bay, Port Stephens, NSW

We were in Nelson Bay on a Saturday and Sunday so the club was not open, we did go for a look and I stalked them on Facebook.

According to the Australian Men's Shed website they do local community projects and personal projects. They are open 8am - 12pm Monday – Friday.

The Facebook page shows that they celebrated their 15 year anniversary last year so that means they probably started in 2007. There is no website for them

The pictures show them at Bunnings (apparently their Bunnings do Christmas markets) and they make and sell Christmas trees.

They also do work for local restaurants making benches and planters etc.

They are on the site of the recycling business which is huge and very busy so they have a ready made audience for the products they have for sale.

**The club from outside the locked gate:**





# What tree is that?

## **Camphor laurel** *Cinnamomum camphora*



Camphor laurel was introduced into Australia from Asia in 1822. It has been planted as a garden ornamental throughout Queensland.

Camphor laurel is an attractive shade tree, but can be very destructive as it aggressively replaces native vegetation. The long-term consequences of its spread may result in the loss of native wildlife and agricultural productivity over large areas of South East Queensland.

It invades pastures and disturbed riparian systems. It tends to germinate under fences and power lines (wherever birds rest and deposit the seed). As a result, it can push fences over and disrupt power facilities.

Camphor laurel can replace the native blue gums, thereby threatening koala populations.

**Notes on Camphor laurel:** The species is cultivated for camphor and timber production. The production and shipment of camphor, in a solid, waxy form, was a major industry in Taiwan prior to and during the Japanese colonial era (1895–1945). It was used medicinally and was also an important ingredient in the production of smokeless gunpowder and celluloid. Primitive stills were set up in the mountainous areas in which the tree is usually found. The wood was chipped; these chips were steamed in a retort, allowing the camphor to crystallize on the inside of a crystallization box after the vapour had passed through a cooling chamber. It was then scraped off and packed out to government-run factories for processing and sale. Camphor was one of the most lucrative of several important government monopolies under the Japanese.

The wood has an insect-repellent quality.

### **Practical Applications**

Despite its ecological drawbacks, Camphor Laurel has found a valuable niche in producing homeware and kitchen products. The wood contains antimicrobial oils that make it particularly suitable for food preparation surfaces. Studies have shown that Camphor Laurel boards harbour minimal fungi and bacteria compared to plastic, glass, and other wood. This makes it an excellent material for cutting boards, salad bowls, and other kitchen items.

At Australian Woodwork, we actively participate in eradication programs, sourcing Camphor Laurel timber to create durable, kiln-dried products that are both functional and aesthetically pleasing.

### **Conclusion**

Camphor Laurel represents a complex case of an invasive species that has found a beneficial role in modern homeware. Its journey from being an ecological pest to becoming a valuable resource demonstrates the potential for innovative solutions in environmental management. By harnessing the antimicrobial properties and unique beauty of Camphor Laurel, we can mitigate its negative impact while creating high-quality, functional, and sustainable homeware products.

Camphor laurel is a favourite turning and cutting board timber for many woodcraft club members.

## Club activity and Show and Tell



Rod Meier working on his guitar



Werner Baumeister putting the finishing touches to his guitar.



Percy Hill and Dan O'Farrell discussing detail of guitar construction/



Dan I talking about the making process of his WIP Lute



President Ernie with his iconic creations from matchsticks that had on display at the clubhouse during his recent lifestyle relocation.



*S & T continued:*



Sean talked through the making process of his segmented cutting board

Jane showed her fist box creation.



Bob Longland tabled his interesting segmented lidded box along with a segmented wall clock.



Michael talked about his making the timber 'block of earth' holding the paper Mache flowers



Michael Culwick had his beautifully carved and painted Noisy Pitta on display



One of Mal's multi timber segmented platter/bowls .



Ed had a nicely ebonised and figured turned platter in mango?





Kerry's last major project from his workshop, a display stand for the Cameron's new abode. (A detailed story of its making should be in the February Redwood) *To big to take to the Club*



Ken Rays did a 'woberly' and a lidded box.



Barry Spillman had more of his wonderful carvings.



John Picard and his carved interpretation of reef coral,



Richard Scriven with the neatly woven seat that he has made for the Canadian canoe that he is making



Ian Hunter and Ernie Hobson accepting a cheque for \$500 from North Lakes RACQ Local Giving program that will be of benefit to our musical instrument makers.



## **SPONSOR HONOUR LIST**

Please give your support to these businesses because they support our Club



<b>Aussie Escape Caravan Repair &amp; Service Specialists</b> 40 South Pine Road, Brendale 4500	07 3205 7738	<a href="http://www.aussieescapecaravans.com.au/">http://www.aussieescapecaravans.com.au/</a>
<b>Abrasiflex</b> Unit 1 22/24 French Avenue Brendale Qld 4500	07 32937001	<a href="http://www.abrasiflex.co..au">www.abrasiflex.co..au</a>
<b>Combined Saw and Knife</b> 105-107 Kabi Circuit, Deception Bay 4508	07 3204 0977	<a href="https://combinedsaw.com.au/contactus">https://combinedsaw.com.au/contactus</a>
<b>Eales Concreting</b>	0407 372 324	
<b>Ernie's Electrical Service</b> 13 Hughendon Crt, Deception Bay 4508	07 3204 9866 0419 388 945	<a href="https://ernieelectricalservice.business.site/">https://ernieelectricalservice.business.site/</a>
<b>Lindsay Meyers</b> 11 Grice St, Clontarf 4019	07 3284 5281	<a href="http://www.lindsaymeyers.com.au/">http://www.lindsaymeyers.com.au/</a>
<b>Moreton Bay Regional Council</b> PO Box 159, Caboolture 4510	07 3205 0555	<a href="https://www.moretonbay.qld.gov.au/contact/">https://www.moretonbay.qld.gov.au/contact/</a>
<b>Utopia Woodcraft, Marilyn Kunde</b> 31 Beech Drv, Cashmere	0403216317	email: zakk@tpg.com.au
<b>Red Poppy Art Collective</b> 95 Redcliffe Pde. Redcliffe 4020	0455963554	<a href="http://www.redpoppyart.com.au">www.redpoppyart.com.au</a>
<b>Signs &amp; Designs</b> 3/16 Paisley Dr, Lawnton 4501	07 3205 4544	<a href="http://www.signsanddesigns.com.au/">http://www.signsanddesigns.com.au/</a>
<b>Sunstate Timbers</b> 72 Lipscombe Rd, Deception Bay 4508	07 3204 253	<a href="http://www.sunstatetimbers.com.au/">http://www.sunstatetimbers.com.au/</a>
<b>Traditional Funerals</b> 17 Anzac Ave, Redcliffe 4020	07 3284 7333	<a href="https://www.traditionalfunerals.com.au/">https://www.traditionalfunerals.com.au/</a>
<b>Vicmarc Machinery Pty Ltd</b> 52 Grice St, Clontarf, 4019	07 3284 3103	<a href="https://vicmarc.com/">https://vicmarc.com/</a>
<b>Woodland Fitouts</b> 13 Bult Street, Brendale, 4500	07 3205 4188	<a href="https://woodlandfitouts.com.a">https://woodlandfitouts.com.a</a>

### **The Redcliffe and District Woodcraft Society Inc. - General Information**

The aim of our society is to promote, encourage and practice the art of woodcraft and similar artsWorkshops in woodturning, woodcarving, scroll sawing, pyrography, box making, musical instrument making, toy making, general woodworking, and timber preparation are held in the Woodcraft Centre at 463 Oxley Avenue, Redcliffe. The Society is administered by a Management Committee of eleven members who report to the general membership.

Members meet on Tuesdays for general workshop activities and our weekly "show and Tell' at morning tea where members can show and discuss their creations and be inspired by the work of others. Our Club is also open to members on Monday, Wednesday, and Thursday mornings.

The Society has a large range of tools and machinery for members to use and offers regular tuition in different aspects of woodcraft. Our club also conducts a comprehensive system of competency in the operations of its machinery. ALL NEW MEMBERS ARE WELLCOME